

NO.	MFG/PUR	ITEM #	Model Number	Description	QTY.	ASM
1		110073		TARGET CLAMP, 137 OD TUBE	1	
2		100355	SC53	TARGET CLAMP 4mm WIRE	1	
3		100270	M8X1.25X20SHCS-BLOX	M8 x 1.25 x 20 SHCS -BX	2	
4		100356	SC53C	TARGET CLAMP 2.5mm WIRE	1	
5	PUR	100101	-350	-350 O-RING, VITON	1	

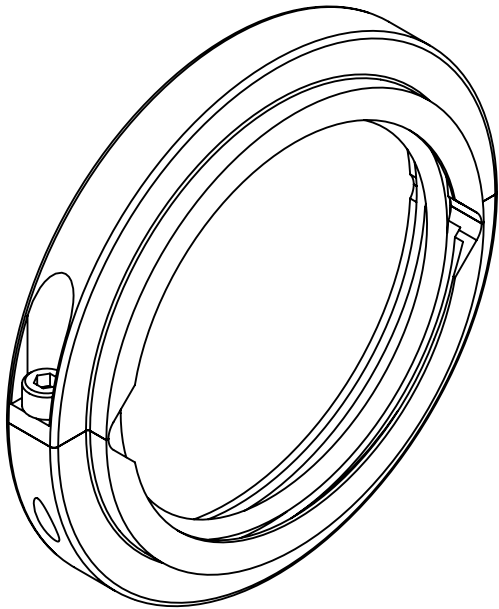
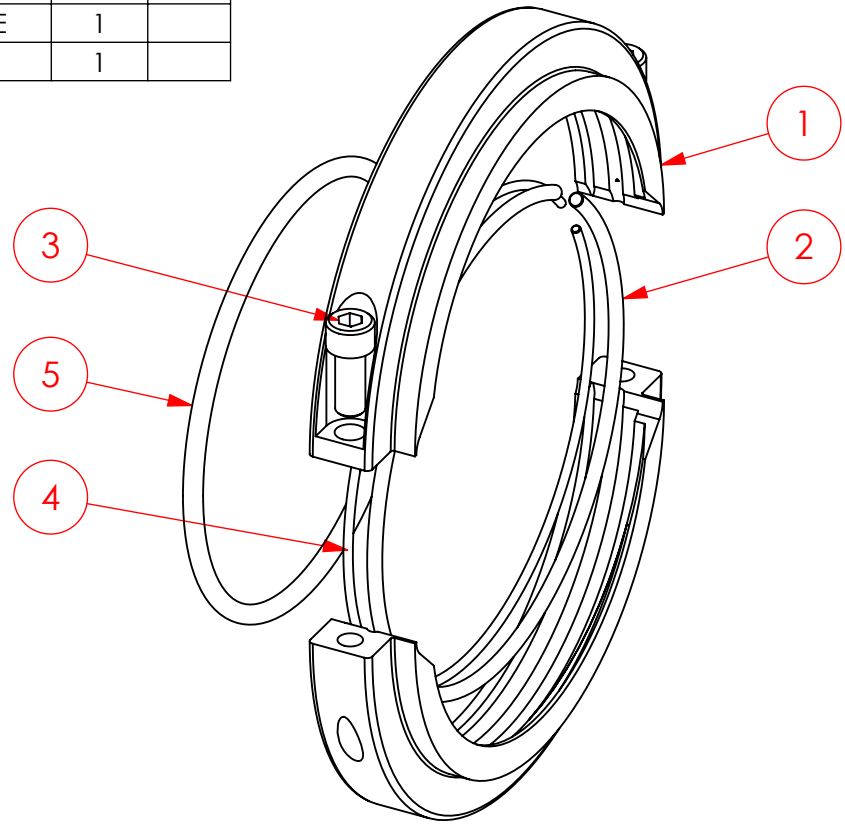

**UNLESS OTHERWISE SPECIFIED:**

**BREAK ALL CORNERS .015 Typ.**

imperial	metric
X.0 = ± .030	X.0 = ± 1
0.X = ± .015	0.X = ± .5
0.XX = ± .010	0.XX = ± .25
0.XXX = ± .005	0.XXX = ± .125

WEIGHT

DRAWN BY

Michelle Neal

DO NOT SCALE DRAWING

**SPUTTERING COMPONENTS, INC.**

375 Alexander Dr. SW, Owatonna, MN 55060

**CONFIDENTIAL:** UNAUTHORIZED USE, MANUFACTURE OR REPRODUCTION IN WHOLE OR IN PART IS PROHIBITED.

**PROPRIETARY TO:** SPUTTERING COMPONENTS, INC.

**TITLE:** 137 TARGET CLAMP ASM FOR CANTILEVER

SIZE

**A**

DATE DRAWN

02/04/2015

PART NO. 110072

MOD NO.

SCALE

1:2

REV

B

MATERIAL:

FINISH:

SHEET 1 OF 1